

# Technical data sheet

FLEXIBLE  
DASHER BOARD

**engo**

ice arena equipment

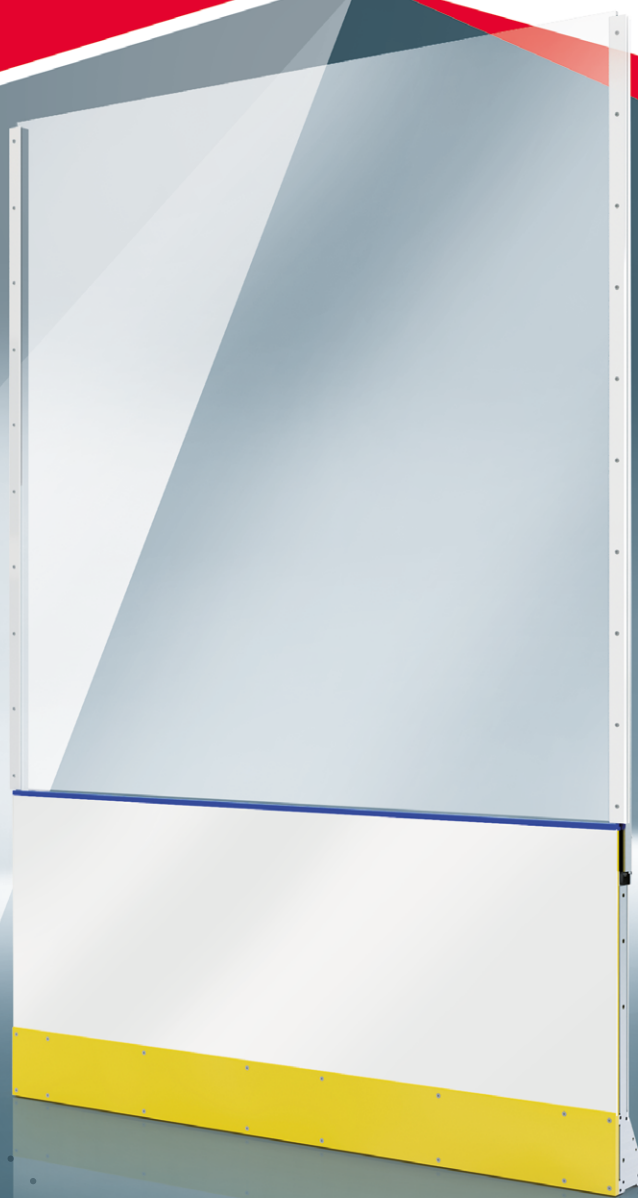

## ***ClassicBoard***

THE CLASSIC SOLUTION

Copyright by ENGO GmbH

## TECHNICAL DATA

- WEIGHT SINGLE ELEMENT** 94 Kg
- HEIGHT SINGLE ELEMENT** 1.100 mm
- LENGHT SINGLE ELEMENT** 2.400 mm
- ELEMENT RADIUS** 7 to 8.5 m
- FRAME CONSTRUCTION** Tubular hot galvanized steel
- ANCHOR TYPE** Immersed adhesive anchor
- INSIDE PANELLING** 10 mm polyethylene
- KICKPLATE** 12 mm thick polyethylene
- HANDRAIL** Polyethylene
- ENTRANCE DOOR** starting from 0.8 m
- MACHINE GATE WIDTH PER DOOR** 1,75 m

## OPTIONALS

- ICE DAM
- QUICK ASSEMBLY SYSTEM
- TEMPERED GLASS SHIELDING (12 OR 15 MM)
- ACRYLIC GLASS SHIELDING (12 TO 15 MM)
- POLYCARBONATE SHIELDING (8, 10 OR 12 MM)
- MACHINE GATE IN RADIUS
- ADVERTISING PROTECTION
- SOUNDPROOFING
- OUTSIDE COVERING
- NET PROTECTION ABOVE SHIELDING
- ADAPTABLE FOR OUTDOOR APPLICATION
- PLAYER-, JURY- AND PENALTYBOXES (PAGE 11)

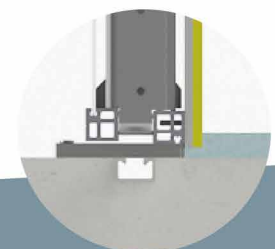
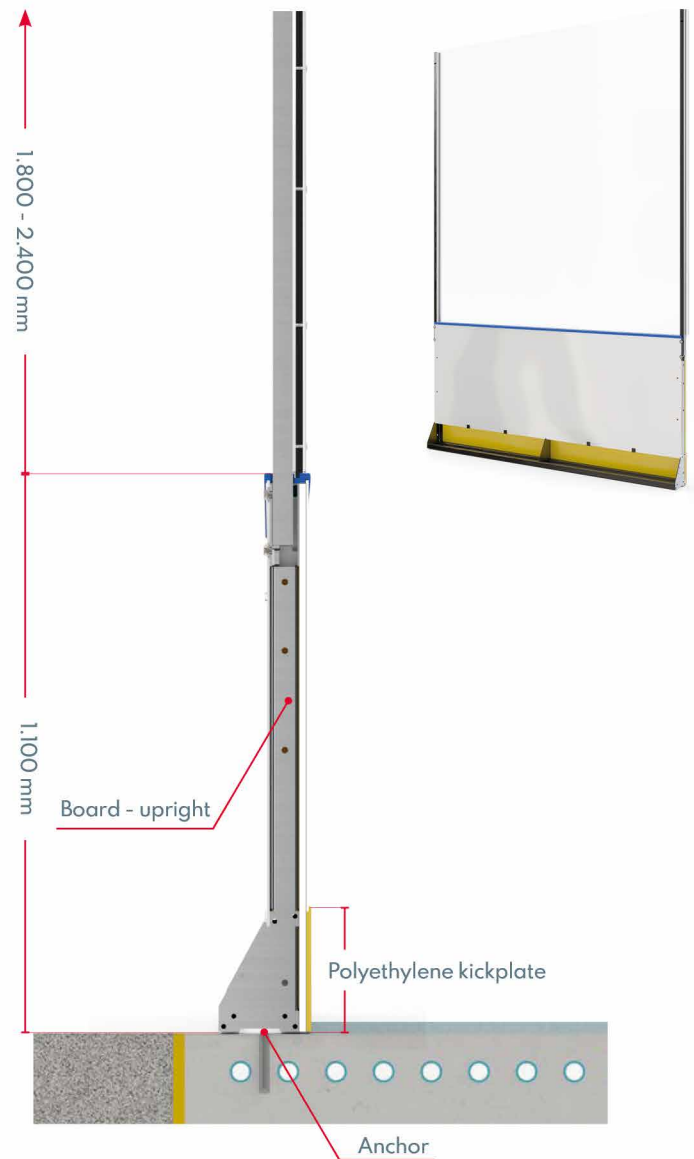
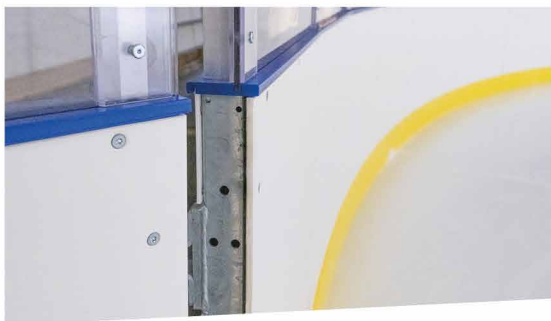

## ANCHORING

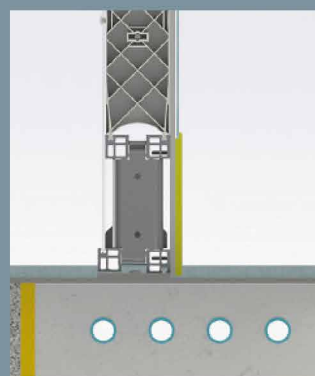

Installation into ice with steel plates

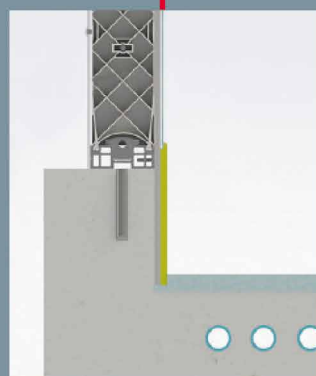

Installation on a barrier

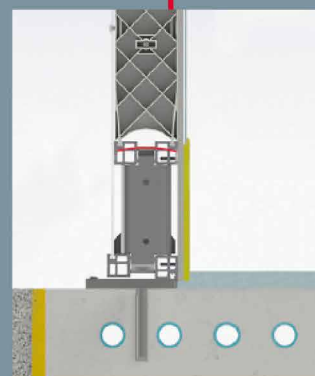

Immersed adhesive anchors

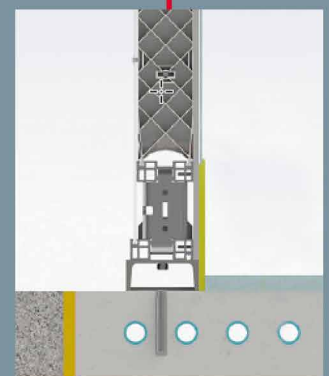

Anchoring system with ice dam

Alternatively  
Immersed steel rail in concrete

# TESTING



## FLEXIBILITY & SAFETY TESTING

There is more than one way to achieve flexibility for dasher boards. On-site impact tests show that there is a marked difference between the values of the various types of boards. These two tables show the difference between the test results for our Flexboard PPS when compared with the results of another type of flexible board. The results confirm the extraordinary flexibility of the Flexboard PPS on both the straight- and the curved sections.

Testresults from 2019, this material is purely for marketing purposes and information may be subject to change by the manufacturer.



## FLEXBOAR CLASSIC IMPACT TESTING

We had our refined ClassicBoard tested with the well renowned institution of AGU Zurich and were pleased with the results. We tested the Acrylic glass in its 15 mm variant and its dynamic characteristics.

The dasher boards were able to achieve up to 80% energy absorption while maintaining structural integrity. Importantly, we were able to retain previous results and further develop the internal structure of the ClassicBoard system, with the goal of greater efficiency. This makes this dasher board certified for competition use.

Testresults from 2022, this material is purely for marketing purposes and information may be subject to change by the manufacturer.





# BOXES

## OPTIONALS

- Players' boxes with „CoachWalkway“
- Benches with back rest and bottle holder
- Inspection openings for players' box flooring
- Roofing for benches and jury box
- Protective padded poles player boxes
- Fully insulated and waterproof jury box with jury table and 6 chairs
- Straight transparent dasher board elements, doors and folding floor of the players' and penalty boxes for quick conversion to Para Ice Hockey.
- Outdoor players' and penalty boxes made of steel with polycarbonat roof, rubber floor and benches. Back rest and bottle holder available upon request at an extra charge.
- Outdoor jury box made of steel with polycarbonat roof, 1 door, rubber floor, jury table and 6 chairs.



INDOOR USE  
**JURY AND PENALTY BOX**

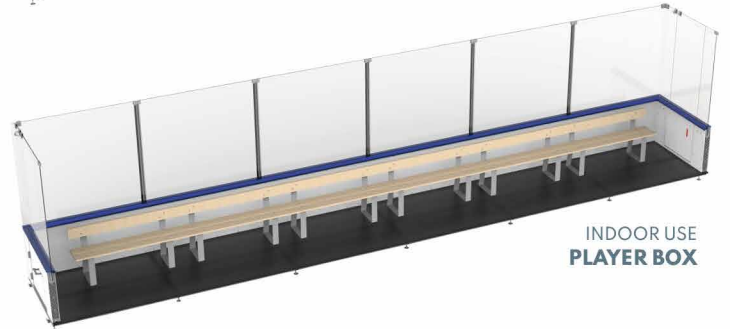

INDOOR USE  
**PLAYER BOX**

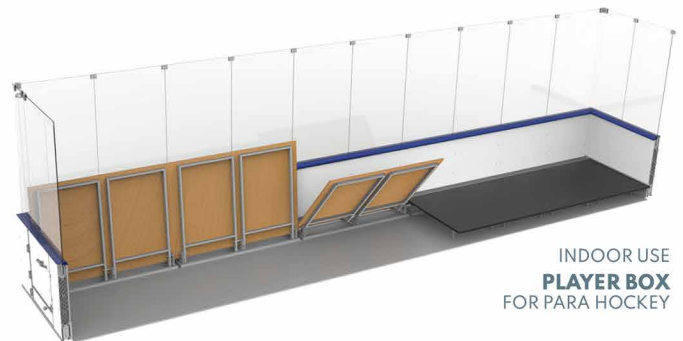

INDOOR USE  
**PLAYER BOX FOR PARA HOCKEY**

IN AND OUTDOOR USE  
**JURY AND PENALTY BOX**



IN AND OUTDOOR USE  
**PLAYER BOX**

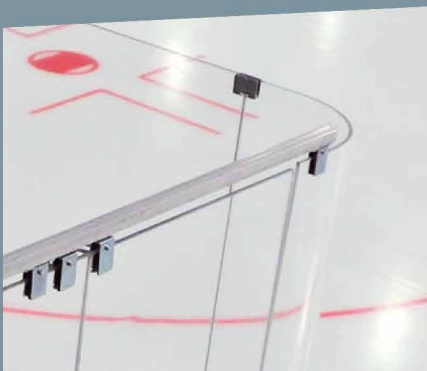
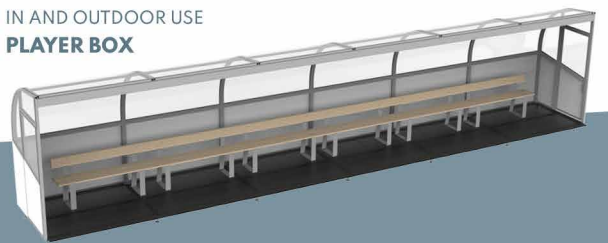

**ROUNDED PROTECTIVE SHIELDING**



**PLAYER BENCHES WITH BACKREST**



**INTEGRATED CUPHOLDERS**

# Quick Adapt

✓ Avoid the high costs of a complete rink reconstruction

✓ Comply with IIHF regulations to host A-League championships

✓ Switch flexibly between the two sizes with one rink

**60x30 m**  
EU-SIZE



**56x26 m\***  
NHL-SIZE



## ONE SYSTEM, MANY SIZES

The innovative, patented QuickAdapt System is the cost-effective alternative to a complete rebuilding to reduce your ice rink to the NHL size. It moves the dasher board with the help of hydraulic cylinders reducing the size of the ice rink by 4 meters within just 3 hours.

\*Size can be set to: 60x30, 60x28, 60x26, 58x28, 56x26 m

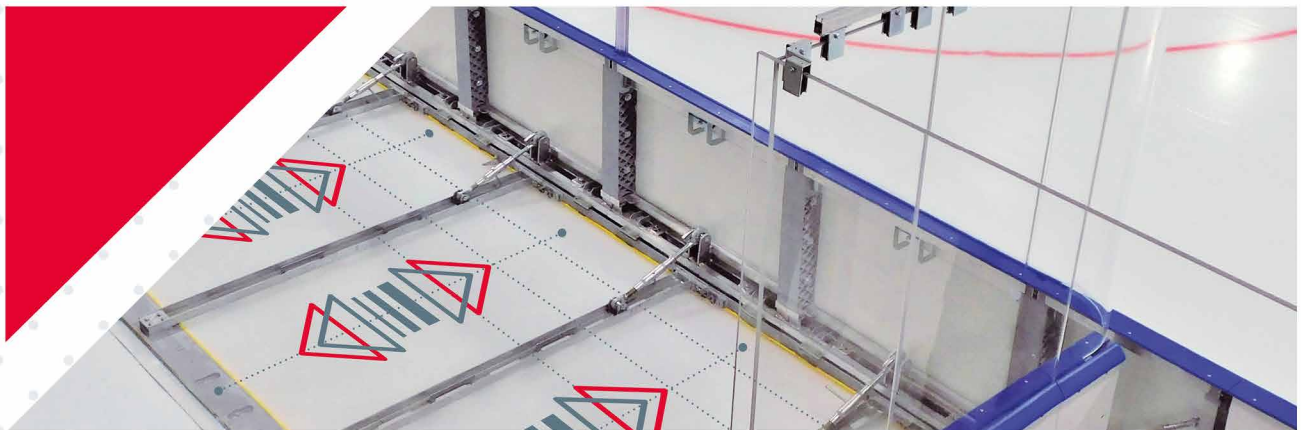



ice arena equipment

**Engo GmbH | S.r.l.**

Forchstraße 9 / Via Forch 9  
39040 Vahrn / Varna (BZ) · Italien / Italy  
T +39 0472 546 157

[info@engo-ice.com](mailto:info@engo-ice.com)  
[www.engo-ice.com](http://www.engo-ice.com)

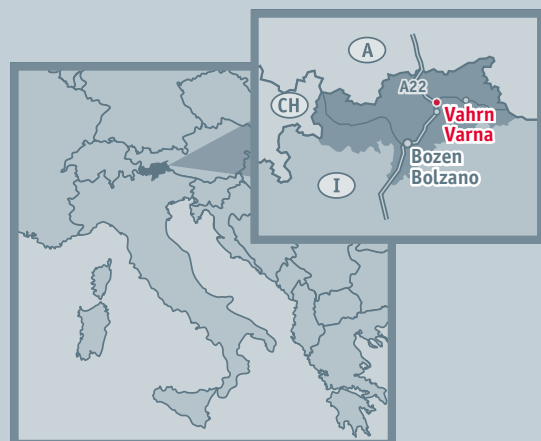

This brochure has been prepared only as a general guide for the customer. Some equipment described or shown may be optional at additional cost. Specifications are subject to change.  
For current product information, please contact the engo Company.

STATUS: 2023/2024

CERTIFICATION



MEMBER



MEMBER OF THE TECHNOALPIN GROUP

